

BARRIER-FREE EXPOSED SHOWER ADA COMPLIANT

SS-5710-_____

surfashower®



SS-5710 Barrier-Free ADA Compliant Shower

ADA Compliant Exposed Shower System

This system is designed to comply with ADA guidelines on mounting heights, operation and clearances. Unit designed for 72" shower head height, valve mounted left, All piping shall be factory preassembled and tested.

Shower Panel

Constructed of 16 gauge stainless steel, #4 finish with recessed soap dish.

Shower Valve – PAM-II-ST-F

Leonard PAM®-II Pressure Actuated Shower Mixer including stainless steel pressure balancing piston, bronze body, single lever handle operation, adjustable limit stop, inlet checkstops. Maximum operating pressure 125 PSI

Shower Head – H-06

Institutional showerhead, brass construction chrome plated, fixed spray, 2.5 GPM, vandal-resistant.

Diverter Valve – D-2L

Lever handle operation to allow transfer of water from showerhead to hand-held shower.

Hand-Held Shower – 100P

Constructed with a 60" stainless steel flexible hose, 2.5 GPM hand shower, wall hook, double check valve, supply elbow and flange.

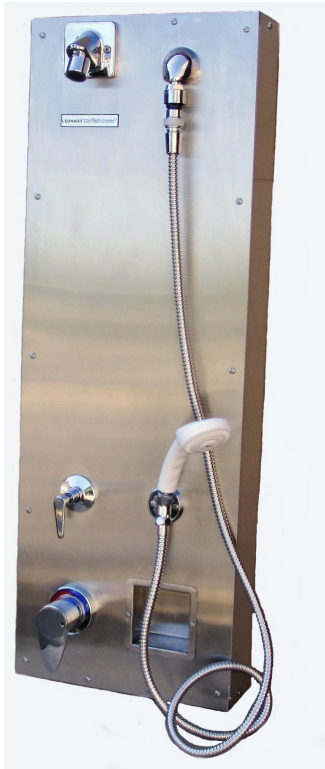

WARNING: This product can expose you to chemicals including lead, which is known to the State of California to cause cancer. For more information, go to www.P65Warnings.Ca.gov

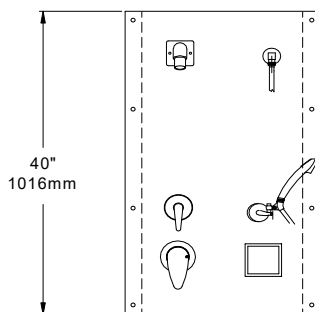
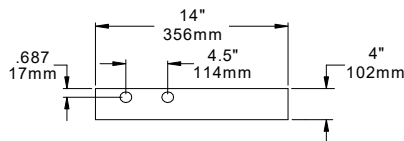

Valve is ASSE 1016 – Type P Certified
Valve is CSA B.125-16 – Type P Certified



NOTE: Grab bar and seat are no longer offered and are NOT included in this assembly

OPTIONS:

- ___ REV Reverses all, valve on right, showerhead, diverter, etc.
- ___ 7600 Leonard 7600 Thermostatic Showermaster® Valve, ASSE TYPE T listed
- ___ H-06-1.5 H-06 head with 1.5 low flow
- ___ H-15 1.5 GPM low flow Shower head
- ___ 105P Hand Shower, 1.5 GPM, all else same as 100P
- ___ 101P(G) Hand Shower, 2.5 GPM, 60" hose, 24" glide bar
- ___ 115P(G) 1.5 GPM low flow hand shower, all else same as 101P(G)

***NOTE:** A limit stop, set for 120°F (49°C), is simply a mechanical setting to prevent excessive handle rotation. If incoming water is hotter than 150°F (65.5°C), the temperature of the factory test, the valve when turned to full HOT may deliver water in excess of 120°F and the limit stop **MUST BE RESET BY THE INSTALLER**



1360 Elmwood Avenue, Cranston, RI 02910 USA
Phone: 401.461.1200 Fax: 401.941.5310
Email: info@leonardvalve.com
WEB: <http://www.leonardvalve.com>

Job # _____

Engineer's Approval

Arch/Eng. _____

Contractor _____